

Gibson

2012 MODEL
44' Classic

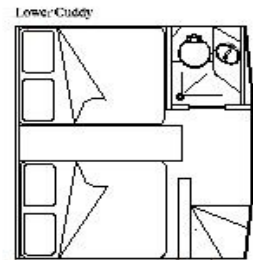
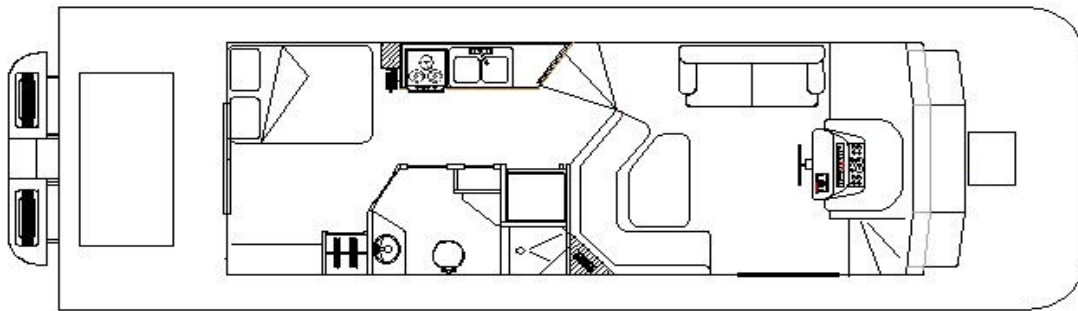
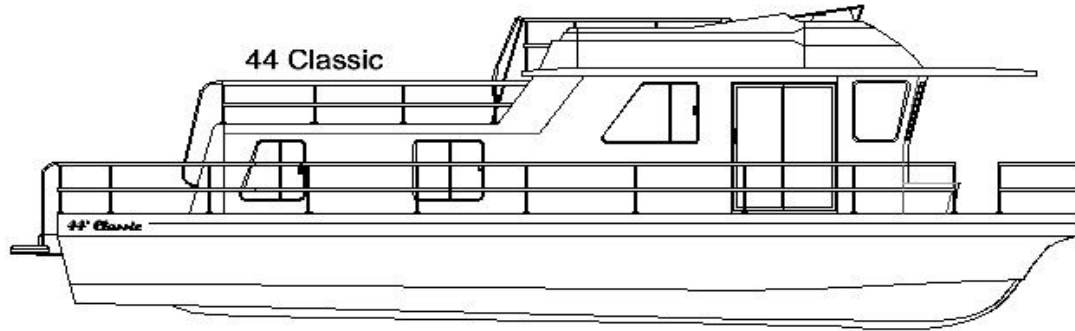

Dimensional Specifications:

Length (Centerline).....	44'0"	13.41 M
Beam (Including Walkways).....	14'0"	4.27 M
Hull Depth:		
Forward.....	4'5"	1.37 M
Aft.....	4'0"	1.22 M
Draft.....	2'4"	.73 M
Walkways.....	1'6"	.49 M
Cabin Length.....	29'0"	8.84 M
Cabin Width.....	11'0"	3.35 M
Cabin Height.....	6'5"	2.01 M
Deck:		
Forward.....	5'8"	1.77 M
Aft.....	7'0"	2.13 M
Sundeck.....	13'0"	3.96 M
Overall Height.....	16'0"	4.88 M
Fuel Capacity.....	240 gals.	908.5 L
Water Capacity.....	100 gals.	378.54 L
Holding Capacity.....	100 gals.	378.54 L
Approximately 20,000 lbs	9071.85 Kg	



Yacht Certification

Design Compliance With NMMA, ABYC and
U.S. Coast Guard Safety Standards

130 Davis Street - Portland, TN 37148
(615) 325-9320 - Fax (615) 325-9321

Website: <http://www.gibsonboats.com> - E-Mail: Sales@gibsonboats.com

2012 MODEL YEAR

		Website: http://www.gibsonboats.com	Verified before production By: _____ Date: _____	
44' Classic		E-mail: sales@gibsonboats.com		
Date: _____		PLEASE REFER TO THIS NO. IN ALL CORRESPONDENCE RELATIVE TO THIS ORDER		B. P. O. _____
S O L D T O		S H I P T O		
44' CLASSIC - TWIN SCREW/V-DRIVE V-8 ENGINES				
Optional TWIN SCREW/V-DRIVE Yanmar 315 Diesel Engines				
STANDARD EQUIPMENT				
Air Conditioner - Cruisair Reverse Cycle (2)		Rudder Indicator System/Dual Station		
Automatic Bilge Pump (2 - Forward & Engine Room)		Safety Chains - Main Deck		
Bath in Lower Stateroom w/Marine Head		Shades/Drapes		
Batteries (3)		Sliding Aft Door		
Battery Charger		Spotlight/Dual Station		
Bilge Blower (4)		Sunbrella Covers		
Captain's Chair Hi/Low		Swim Platform Fiberglass/Metal w/Ladder		
Carbon Monoxide Detector (3 Locations)		Synchronizer System/Dual Station		
Compass		Thermal Pane Windows		
Courtesy Light		Windshield Wiper (1)		
Deluxe Queen Bed				
Deluxe Stereo AM/FM CD				
Dual 50-amp Service		OPTIONAL EQUIPMENT		
Engine Hatch Assist Lift				
Extended Cornice w/Halogen Lighting		Additional Helm Chair Package		
Exterior Convenience Lighting		Helm Chair Pkg w/Vision-Air™ Seats		
Extra Fuel Capacity (240 Gal. Total)		Aft Hard Top		
Fire Extinguisher System (f.e. 241)		Bimini for Flybridge - 8ft		
Flooring - Choice of Berber or Plush Pile Carpet		Bimini for Flybridge - 12 ft		
Flybridge w/Seating		Bimini for Sundeck - 10 ft		
Flybridge Windshield		Bimini for Sundeck - 12 ft		
Fresh Water Cooling - Salt Water Pack		Central Vacuum System		
Generator 10.0 kw - Kohler - Low CO		Custom Drapes		
Head - Deluxe Design (1-Aft)		Engine Mufflers - Centek		
Head - Par Electric (1-Fwd)		Engine Mufflers - Daper		
Hour Meter (2)		Flybridge Stereo		
Hydraulic Steering		Flybridge Wetbar		
Icemaker for Upright Refrigerator		Forward Sheer w/Docking Lights, waterproof speakers & stereo control		
Insulated Walls		Inverter System - 3100 Watt		
Interior - Choice of Dark Maple or Light Maple		Laminate Hardwood Flooring		
Interior Furniture		Upgrade to AGM Deep Cycle Batteries		
Lower Stateroom with Twin Full-Size Beds		Water/Holding Tank Indicator		
Microwave/Built-In		Zincs		
Mood Lighting				
Overhead Console				
Phone/TV Installation (2 Locations)		COLOR SELECTION:		
Power Monitor (2)		Exterior Trim Stripe:		
Pressurized Hot & Cold Water System		Carpet # _____	Captain's Chair # _____	
Privacy Door Aft		Hide-A-Bed # _____	Dinette # _____	
Range Electric w/Oven		L/S Mattress # _____	Headboards # _____	
Raw Water Strainer - Engine (2)		Bar Stools # _____	Drapes # _____	
Raw Water Strainer - Generator		Bed Spread # _____	Shades # _____	
Refrigerator		Bimini _____	Sunbrella _____	
*Optional Equipment & Accessories--Prices Apply Only When Included in Original Order--Prices Subject to Change Without Notice		THIS ORDER IS SUBJECT TO AVAILABILITY AND FINAL APPROVAL BY GIBSON BOATS, LLC, PORTLAND, TN. AN ACKNOWLEDGEMENT WILL BE SENT		
		Please Advise Promptly if Incorrect _____ Dealer Signature		

Gibson[®]

2012 MODEL
47' Classic

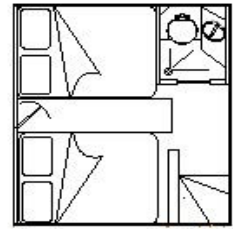
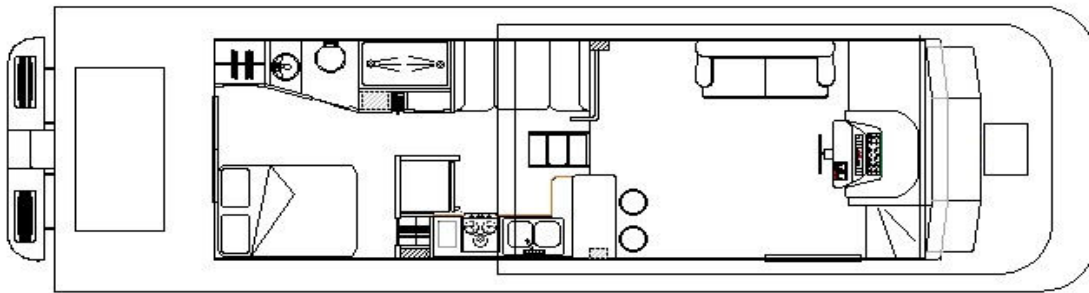
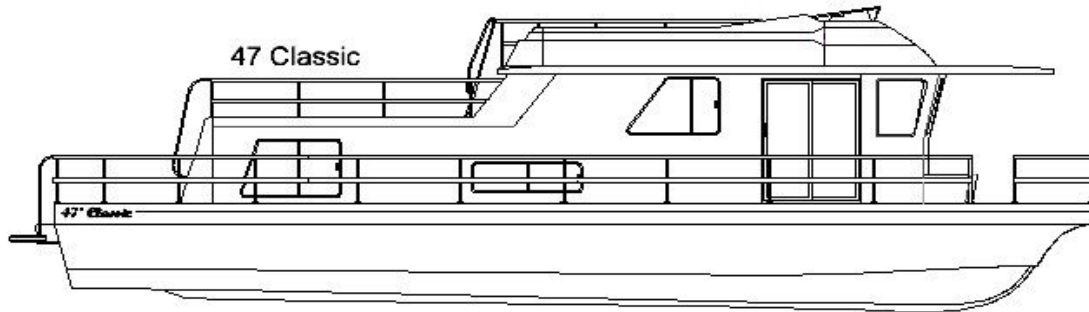

Dimensional Specifications:

Length (Centerline).....	47'0"	14.33 M
Beam (Including Walkways).....	14'0"	4.27 M
Hull Depth:		
Forward.....	4'5"	1.37 M
Aft.....	4'0"	1.22 M
Draft.....	2'4"	.73 M
Walkways.....	1'6"	.49 M
Cabin Length.....	32'0"	9.75 M
Cabin Width.....	11'0"	3.35 M
Cabin Height.....	6'5"	2.01 M
Deck:		
Forward.....	5'8"	1.77 M
Aft.....	7'0"	2.13 M
Sundeck.....	13'0"	3.96 M
Overall Height.....	16'0"	4.88 M
Fuel Capacity.....	240 gals.	908.5 L
Water Capacity.....	100 gals.	378.54 L
Holding Capacity.....	100 gals.	378.54 L
Approximately 21,600 lbs	9797.60 Kg	



KOHLER[®]



Yacht Certification

Design Compliance With NMMA, ABYC and
U.S. Coast Guard Safety Standards

130 Davis Street - Portland, TN 37148
(615) 325-9320 - Fax (615) 325-9321

Website: <http://www.gibsonboats.com> - E-Mail: Sales@gibsonboats.com

2012 MODEL YEAR

		Website: http://www.gibsonboats.com	Verified before production By: _____ Date: _____	
47' Classic		E-mail: sales@gibsonboats.com		
Date: _____		PLEASE REFER TO THIS NO. IN ALL CORRESPONDENCE RELATIVE TO THIS ORDER		B. P. O. _____
S O L D T O		S H I P T O		
47' CLASSIC - TWIN SCREW/V-DRIVE V-8 ENGINES				
Optional TWIN SCREW/V-DRIVE Yanmar 315 Diesel Engines				
STANDARD EQUIPMENT				
Air Conditioner - Cruisair Reverse Cycle (2)		Rudder Indicator System/Dual Station		
Automatic Bilge Pump (2 - Forward & Engine Room)		Safety Chains - Main Deck		
Bath in Lower Stateroom w/Marine Head		Sliding Aft Door		
Batteries (3)		Shades/Drapes		
Battery Charger		Spotlight/Dual Station		
Bilge Blower (4)		Sunbrella Covers		
Captain's Chair Hi/Low		Swim Platform Fiberglass/Metal w/Ladder		
Carbon Monoxide Detector (3 Locations)		Synchronizer System/Dual Station		
Compass		Thermal Pane Windows		
Courtesy Light		Windshield Wiper (1)		
Deluxe Queen Bed				
Deluxe Stereo AM/FM CD		OPTIONAL EQUIPMENT		
Dual 50-amp Service				
Engine Hatch Assist Lift		Additional Helm Chair Package		
Extended Cornice w/Halogen Lighting		Helm Chair Pkg w/Vision-Air™ Seats		
Exterior Convenience Lighting		Aft Hard Top		
Extra Fuel Capacity (240 Gal. Total)		Bimini for Flybridge - 8ft		
Fire Extinguisher System (f.e. 241)		Bimini for Flybridge - 12 ft		
Flooring - Choice of Berber or Plush Pile Carpet		Bimini for Sundeck - 10 ft		
Flybridge w/Seating		Bimini for Sundeck - 12 ft		
Flybridge Windshield		Central Vacuum System		
Fresh Water Cooling - Salt Water Pack		Custom Drapes		
Generator 10.0 kw - Kohler - Low CO		Engine Mufflers - Centek		
Head - Deluxe Design (1-Aft)		Engine Mufflers - Daper		
Head - Par Electric (1-Fwd)		Flybridge Stereo		
Hour Meter (2)		Flybridge Wetbar		
Hydraulic Steering		Forward Sheer w/Docking Lights, waterproof speakers & stereo control		
Icemaker for Upright Refrigerator		Inverter System - 3100 Watt		
Insulated Walls		Laminate Hardwood Flooring		
Interior - Choice of Dark Maple or Light Maple		Upgrade to AGM Deep Cycle Batteries		
Interior Furniture		Water/Holding Tank Indicator		
Lower Stateroom with Twin Full-Size Beds		Zincs		
Microwave/Built-In				
Mood Lighting				
Overhead Console				
Phone/TV Installation (1 Location)		COLOR SELECTION:		
Power Monitor (2)		Exterior Trim Stripe:		
Pressurized Hot & Cold Water System		Carpet #	Captain's Chair #	
Privacy Door Aft		Hide-A-Bed #	Dinette #	
Range Electric w/Oven		L/S Mattress #	Headboards #	
Raw Water Strainer - Engine (2)		Bar Stools #	Drapes #	
Raw Water Strainer - Generator		Bed Spread #	Shades	
Refrigerator		Bimini	Sunbrella	
*Optional Equipment & Accessories--Prices Apply Only When Included in Original Order--Prices Subject to Change Without Notice		THIS ORDER IS SUBJECT TO AVAILABILITY AND FINAL APPROVAL BY GIBSON BOATS, LLC, PORTLAND, TN. AN ACKNOWLEDGEMENT WILL BE SENT		
		Please Advise Promptly if Incorrect _____ Dealer Signature		

Gibson[®]

2012 MODEL
50' Classic

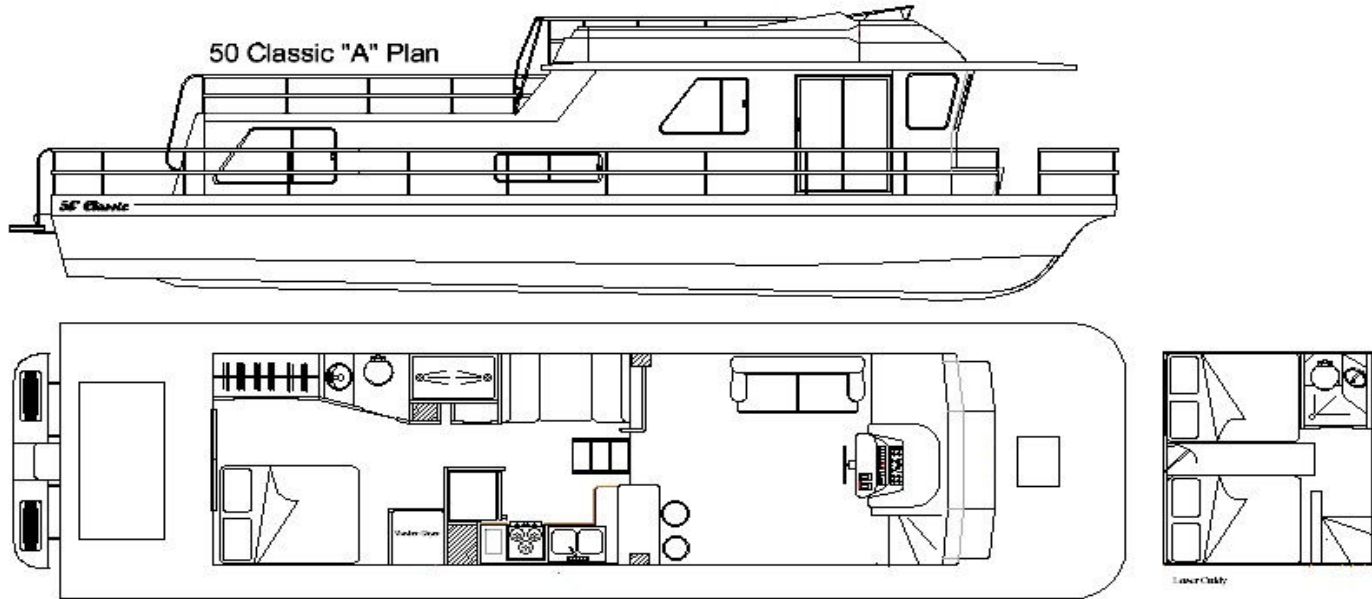

Dimensional Specifications:

Length (Centerline).....	50'0"	15.24 M
Beam (Including Walkways).....	14'0"	4.27 M
Hull Depth:		
Forward.....	4'5"	1.37 M
Aft.....	4'0"	1.22 M
Draft.....	2'4"	.73 M
Walkways.....	1'6"	.49 M
Cabin Length.....	34'0"	10.36 M
Cabin Width.....	11'0"	3.35 M
Cabin Height.....	6'5"	2.01 M
Deck:		
Forward.....	5'8"	1.77 M
Aft.....	7'0"	2.13 M
Sundeck.....	14'0"	4.27 M
Overall Height.....	16'0"	4.88 M
Fuel Capacity.....	240 gals.	908.5 L
Water Capacity.....	120 gals.	454.25 L
Holding Capacity.....	100 gals.	378.54 L
Approximately 23,000 lbs	10432.62 Kg	



KOHLER



Yacht Certification

**Design Compliance With NMMA, ABYC and
U.S. Coast Guard Safety Standards**

130 Davis Street - Portland, TN 37148
(615) 325-9320 - Fax (615) 325-9321

Website: <http://www.gibsonboats.com> - E-Mail: Sales@gibsonboats.com

2012 MODEL YEAR

		Website: http://www.gibsonboats.com	Verified before production By: _____ Date: _____	
50' Classic		E-mail: sales@gibsonboats.com		
Date: _____		PLEASE REFER TO THIS NO. IN ALL CORRESPONDENCE RELATIVE TO THIS ORDER		B. P. O. _____
S O L D T O		S H I P T O		
50' CLASSIC - TWIN SCREW/V-DRIVE V-8 ENGINES				
Optional TWIN SCREW/V-DRIVE Yanmar 315 Diesel Engines				
STANDARD EQUIPMENT				
Air Conditioner - Cruisair Reverse Cycle (2)		Rudder Indicator System/Dual Station		
Automatic Bilge Pump (2 - Forward & Engine Room)		Safety Chains - Main Deck		
Bath in Lower Stateroom w/Marine Head		Shades/Drapes		
Batteries (3)		Sliding Aft Door		
Battery Charger		Spotlight/Dual Station		
Bilge Blower (4)		Sunbrella Covers		
Captain's Chair Hi/Low		Swim Platform Fiberglass/Metal w/Ladder		
Carbon Monoxide Detector (3 Locations)		Synchronizer System/Dual Station		
Compass		Thermal Pane Windows		
Courtesy Light		Washer/Dryer		
Deluxe Queen Bed		Windshield Wiper (1)		
Deluxe Stereo AM/FM CD				
Dual 50-amp Service		OPTIONAL EQUIPMENT		
Engine Hatch Assist Lift				
Extended Cornice w/Halogen Lighting		Additional Helm Chair Package		
Exterior Convenience Lighting		Helm Chair Pkg w/Vision-Air™ Seats		
Extra Fuel Capacity (240 Gal. Total)		Aft Hard Top		
Fire Extinguisher System (f.e. 241)		Bimini for Flybridge - 8ft		
Flooring - Choice of Berber or Plush Pile Carpet		Bimini for Flybridge - 12 ft		
Flybridge w/Seating		Bimini for Sundeck - 10 ft		
Flybridge Windshield		Bimini for Sundeck - 12 ft		
Fresh Water Cooling - Salt Water Pack		Central Vacuum System		
Generator 10.0 kw - Kohler - Low CO		Custom Drapes		
Head - Deluxe Design (1-Aft)		Engine Mufflers - Centek		
Head - Par Electric (1-Fwd)		Engine Mufflers - Daper		
Hour Meter (2)		Flybridge Stereo		
Hydraulic Steering		Flybridge Wetbar		
Icemaker for Upright Refrigerator		Forward Sheer w/Docking Lights, waterproof speakers & stereo control		
Insulated Walls		Inverter System - 3100 Watt		
Interior - Choice of Dark Maple or Light Maple		Laminate Hardwood Flooring		
Interior Furniture		Upgrade to AGM Deep Cycle Batteries		
Lower Stateroom with Twin Full-Size Beds		Water/Holding Tank Indicator		
Microwave/Built-In		Zincs		
Mood Lighting				
Overhead Console				
Phone/TV Installation (1 Location)		COLOR SELECTION:		
Power Monitor (2)		Exterior Trim Stripe:		
Pressurized Hot & Cold Water System		Carpet # _____	Captain's Chair # _____	
Privacy Door Aft		Hide-A-Bed # _____	Dinette # _____	
Range Electric w/Oven		L/S Mattress # _____	Headboards # _____	
Raw Water Strainer - Engine (2)		Bar Stools # _____	Drapes # _____	
Raw Water Strainer - Generator		Bed Spread # _____	Shades _____	
Refrigerator		Bimini _____	Sunbrella _____	
*Optional Equipment & Accessories--Prices Apply Only When Included in Original Order--Prices Subject to Change Without Notice		THIS ORDER IS SUBJECT TO AVAILABILITY AND FINAL APPROVAL BY GIBSON BOATS, LLC, PORTLAND, TN. AN ACKNOWLEDGEMENT WILL BE SENT		
		Please Advise Promptly if Incorrect _____ Dealer Signature		